



A **PRIDEONE** DEVELOPMENT  
CONSTRUCTION

\*BIRDS EYE VIEW LOOKING NORTHEAST

# SOUTHLAND DISTRICT MIXED-USE DEVELOPMENT

6875 Southland Drive  
Middleburg Heights, Ohio 44130

# FOR LEASE

# SOUTHLAND DISTRICT MIXED-USE DEVELOPMENT

6875 Southland Drive | Middleburg Heights, Ohio 44130



## HIGHLIGHTS

- ▶ Up to +/- 14,000 SF of **retail and restaurant space with dramatic two-story ceiling heights**, allowing for strong storefront presence, abundant natural light, and flexibility for creative build-outs
- ▶ **On-site built-in customer base with 170 upscale, modern-style residential units**, (250+ projected residents) providing consistent daily foot traffic and a true live-work-play environment
- ▶ **Direct connectivity to a multi-purpose walking trail linking to the MetroParks system**, capturing recreational traffic and enhancing appeal for fitness, wellness, food & beverage, and experiential users
- ▶ **Publicly accessible central courtyard** designed as a community gathering space, featuring outdoor seating and programmed areas ideal for dining, social interaction, and events
- ▶ **Strategic adjacency to the new Meijer at Southland** along the I-71 corridor, driving significant new daily traffic and convenient regional draw



**MATT WILSON** | 216.342.2580 | [mwilson@anchorretail.com](mailto:mwilson@anchorretail.com)  
**ALLISON GIOMUSO** | 216.342.2620 | [agiomuso@anchorretail.com](mailto:agiomuso@anchorretail.com)

# FOR LEASE

# SOUTHLAND DISTRICT MIXED-USE DEVELOPMENT

6875 Southland Drive | Middleburg Heights, Ohio 44130

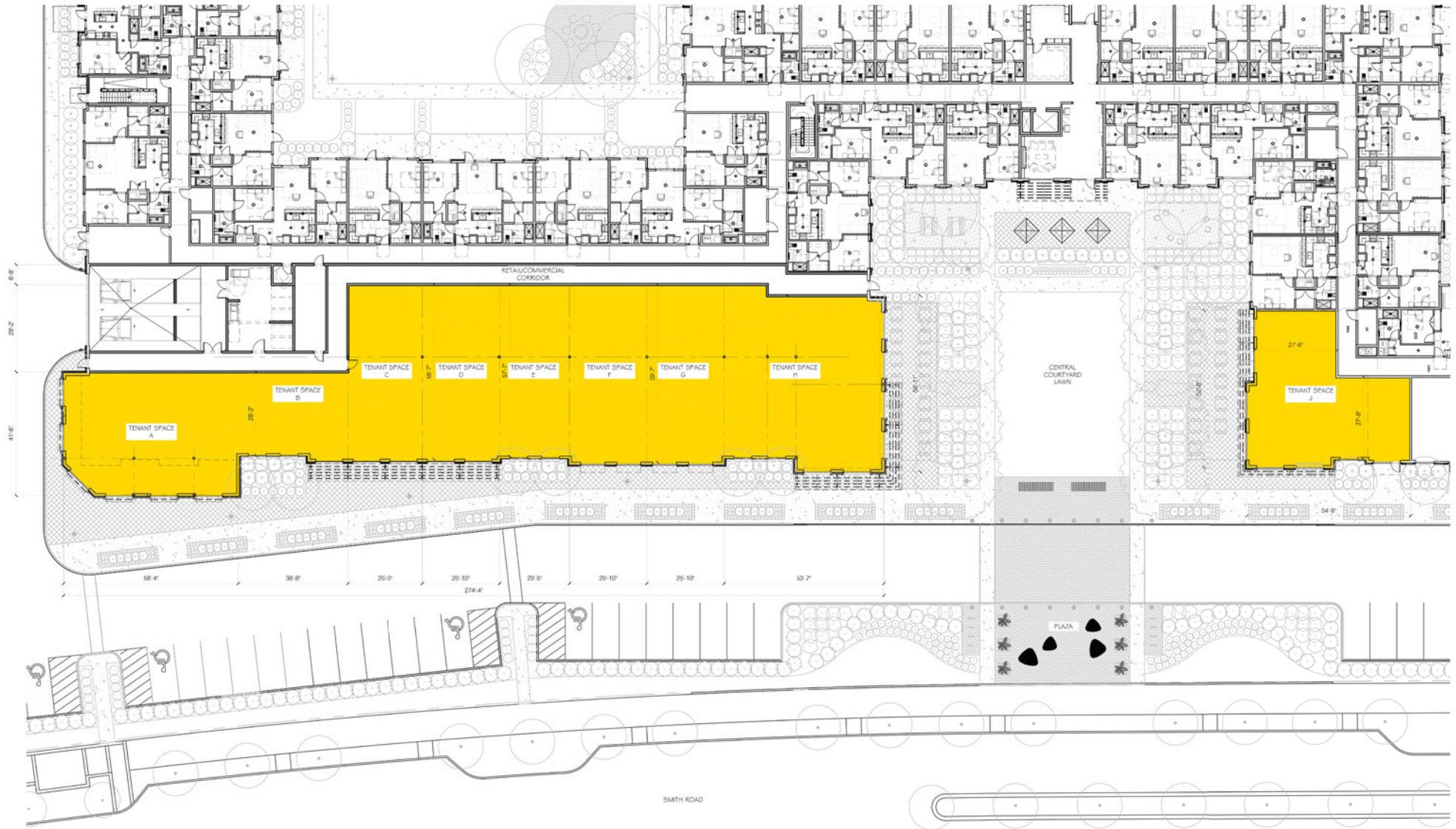

# FOR LEASE

# SOUTHLAND DISTRICT MIXED-USE DEVELOPMENT

6875 Southland Drive | Middleburg Heights, Ohio 44130



# FOR LEASE

# SOUTHLAND DISTRICT MIXED-USE DEVELOPMENT

6875 Southland Drive | Middleburg Heights, Ohio 44130

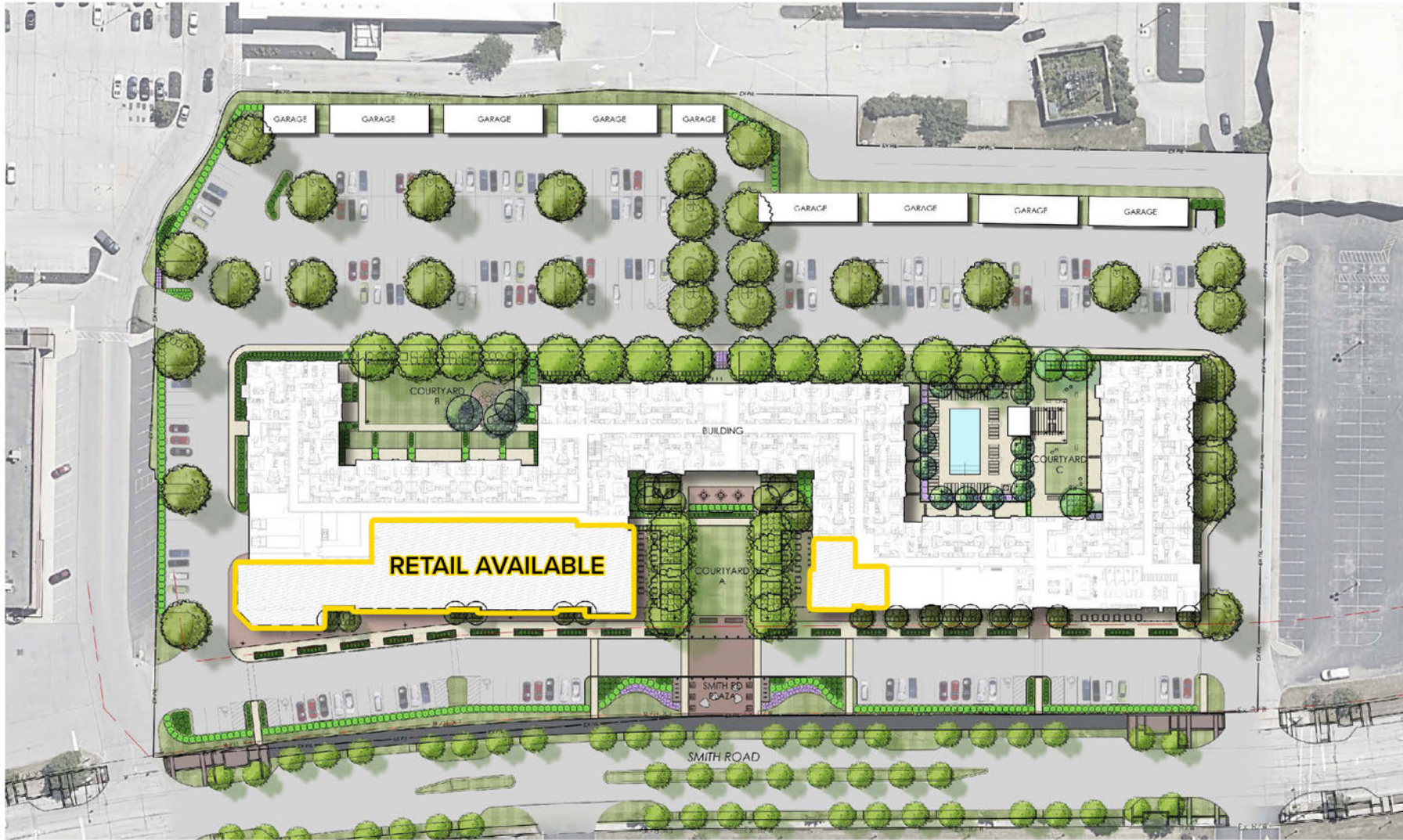

**SITE PLAN**



**MATT WILSON** | 216.342.2580 | [mwilson@anchorretail.com](mailto:mwilson@anchorretail.com)  
**ALLISON GIOMUSO** | 216.342.2620 | [agiomuso@anchorretail.com](mailto:agiomuso@anchorretail.com)

FOR LEASE

SOUTHLAND DISTRICT MIXED-USE DEVELOPMENT  
6875 Southland Drive | Middleburg Heights, Ohio 44130



\*VIEW FROM WEST LOOKING TOWARD PUBLIC PLAZA



MATT WILSON | 216.342.2580 | [mwilson@anchorretail.com](mailto:mwilson@anchorretail.com)  
ALLISON GIOMUSO | 216.342.2620 | [agiomuso@anchorretail.com](mailto:agiomuso@anchorretail.com)

FOR LEASE

SOUTHLAND DISTRICT MIXED-USE DEVELOPMENT  
6875 Southland Drive | Middleburg Heights, Ohio 44130



\*VIEW FROM NORTHWEST CORNER



MATT WILSON | 216.342.2580 | [mwilson@anchorretail.com](mailto:mwilson@anchorretail.com)  
ALLISON GIOMUSO | 216.342.2620 | [agiomuso@anchorretail.com](mailto:agiomuso@anchorretail.com)

# FOR LEASE

# SOUTHLAND DISTRICT MIXED-USE DEVELOPMENT

6875 Southland Drive | Middleburg Heights, Ohio 44130



# FOR LEASE

# SOUTHLAND DISTRICT MIXED-USE DEVELOPMENT

6875 Southland Drive | Middleburg Heights, Ohio 44130

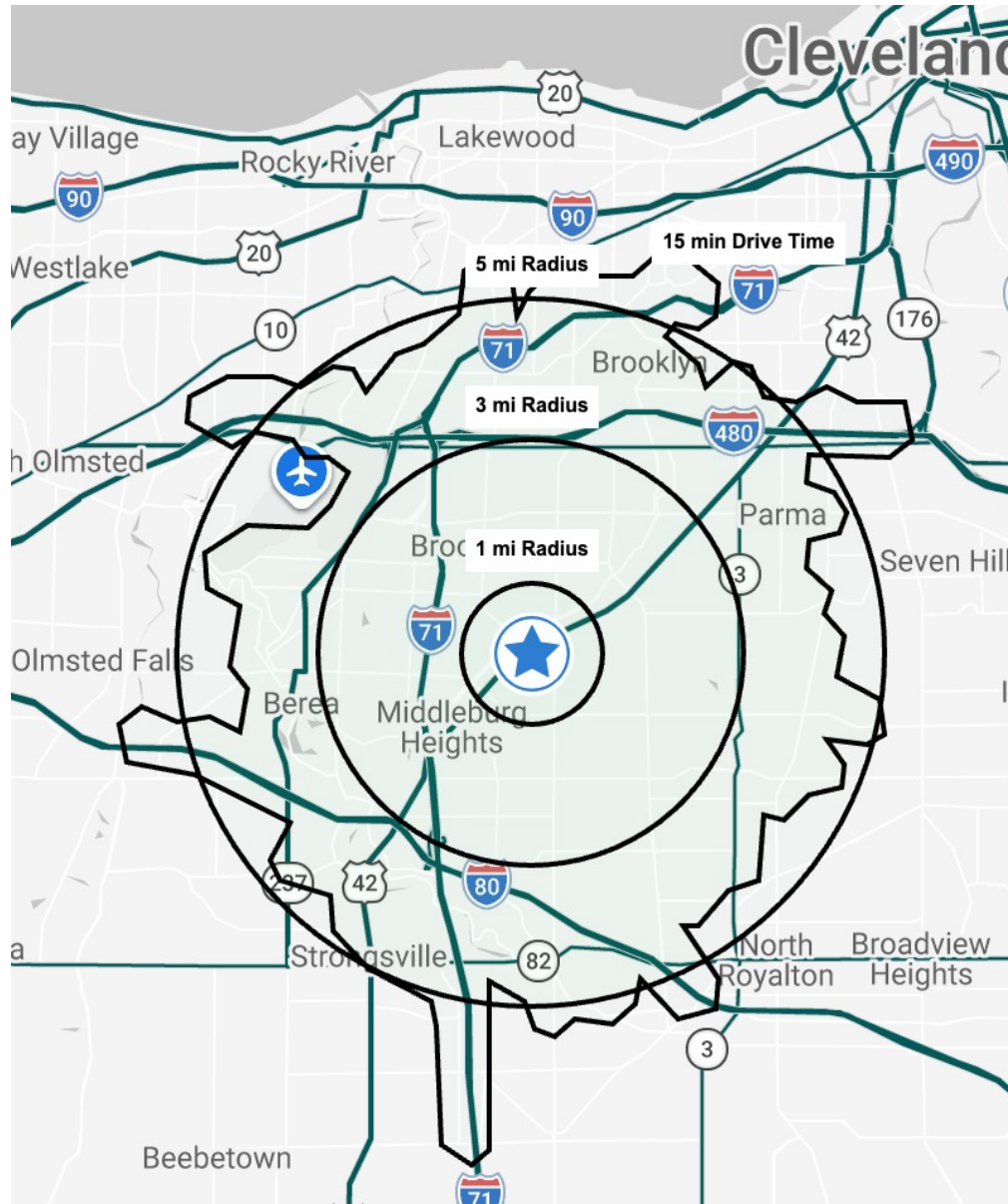

## DEMOGRAPHIC SNAPSHOT

	1 MILE	3 MILES	5 MILES	15 MIN DRIVE
POPULATION	8,719	80,899	207,893	210,179
HOUSEHOLDS	3,746	36,037	91,835	92,744
MEDIAN AGE	46.3	44.4	42.7	42.3
AVERAGE HH INCOME	\$95,723	\$94,815	\$95,963	\$94,521
MEDIAN HH INCOME	\$77,984	\$74,088	\$73,378	\$72,447
BUSINESSES	462	2,760	7,346	7,476
EMPLOYEES	4,942	40,540	101,682	101,825
EDUCATION: BACHELORS +	28.6%	29.9%	30.0%	29.5%



MATT WILSON | 216.342.2580 | mwilson@anchorretail.com

ALLISON GIOMUSO | 216.342.2620 | agiomuso@anchorretail.com

Cleveland • Columbus | [www.anchorretail.com](http://www.anchorretail.com)

The information submitted herein is not guaranteed. Although obtained from reliable resources, it is subject to errors, omissions, prior sale and withdrawal from the market without notice. Anchor Cleveland, LLC DBA Anchor Retail, and its agents, associates, and employees make no guarantee, warranty, or representation of the property. All images contained here in are the property of Anchor Cleveland, LLC DBA Anchor Retail, and shall not be duplicated or reproduced without express written consent of Anchor Cleveland, LLC DBA Anchor Retail. © 2026